

MoliCare® Premium Elastic

Fitting guide for patients in a standing position



How to select the correct size?

Using a tape measure, measure at the tip of the hip bone to select the correct size.

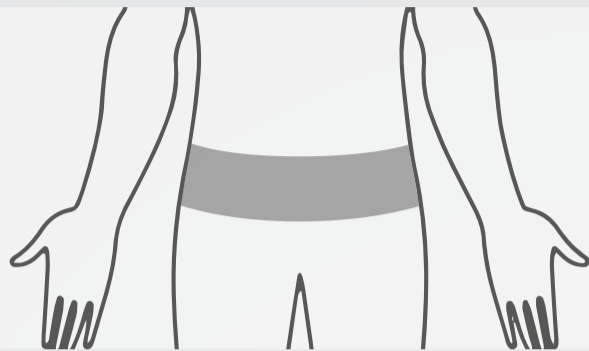

hip measurement	size
70 - 90 cm	S
85 - 120 cm	M
115 - 145 cm	L
140 - 175 cm	XL

4-step guide to slip fitting



Fold and cup the slip to get it ready for application.



Stand beside the patient. Slide the slip between the legs from the front to the back. Ensure that the slip is centred in the right position by aligning the wetness indicator in line with the spine.

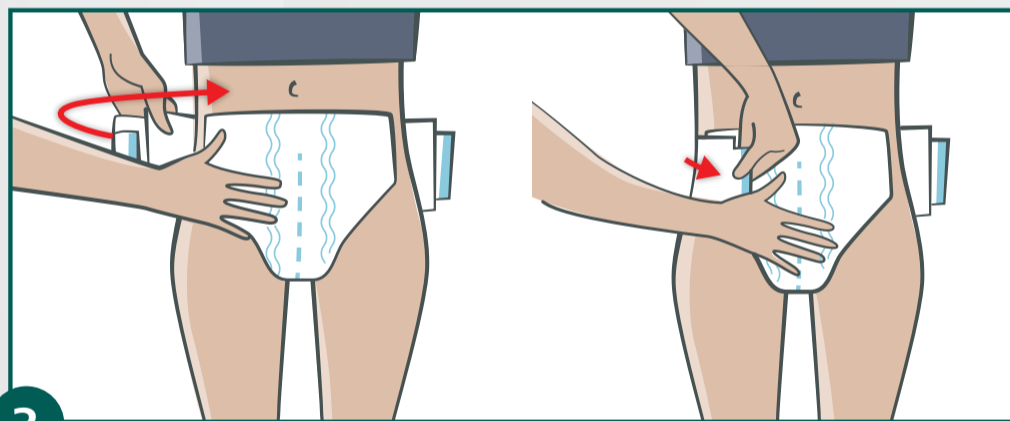

Fold out the 1st side panel and wrap around the patient's hip.

Secure the adhesive tape into position.

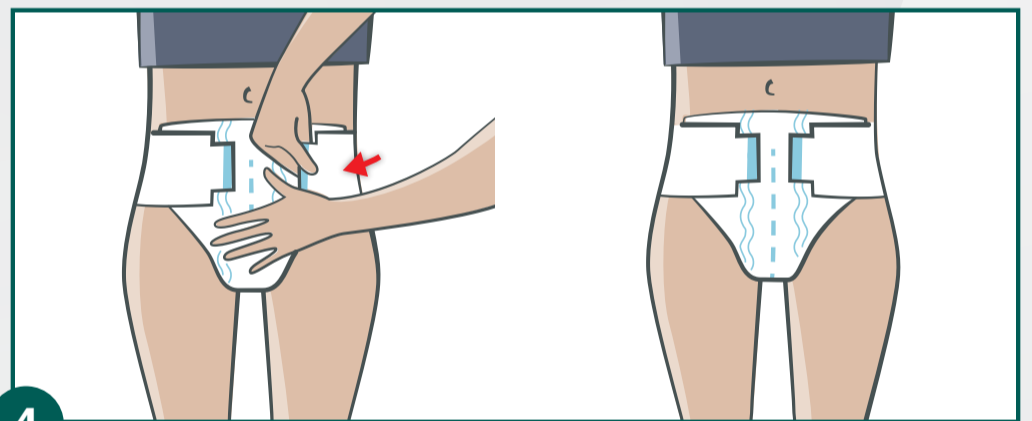

Fold out the 2nd side panel and wrap around the patient's hip.

Secure the adhesive tape into position.

Key benefits & principles



Ergonomics in the workplace:

Faster application reduces handling and physical stress**.

CAREGIVER



Improved comfort, security and hygiene:

Elastic flexibility allows more patients to wear the product with comfort and security.

Removing the slip from the back ensures lower risk of faecal contamination.

PATIENT

Dignity:

Quick and easy application and the ability to reposition tapes reduces changing times.

www.hartmann.com.au



*Product available in 1st half of 2019. **Laboratory report about ergonomic evaluation of MoliCare® variants A+B incontinence products. Research conducted between 5-8 October 2015 in Dijon, France. W. Schneider, H. Mutschler, R. Haller, C. le Mathe. Comparison with a slip having 4 side panels and 4 tapes. PAUL HARTMANN Pty Ltd. ABN 35 000 099 589. Level 5, 1 Thomas Holt Drive Macquarie Park NSW 2113. PO Box 943 North Ryde BC NSW 1670 © Registered trademark PAUL HARTMANN AG. 9166450 / April 2019

